

Users Manual

**FastSystem[®] WISHBONE[®]
Retractor System**



A Division of Minnesota Scientific, Inc.

System Components

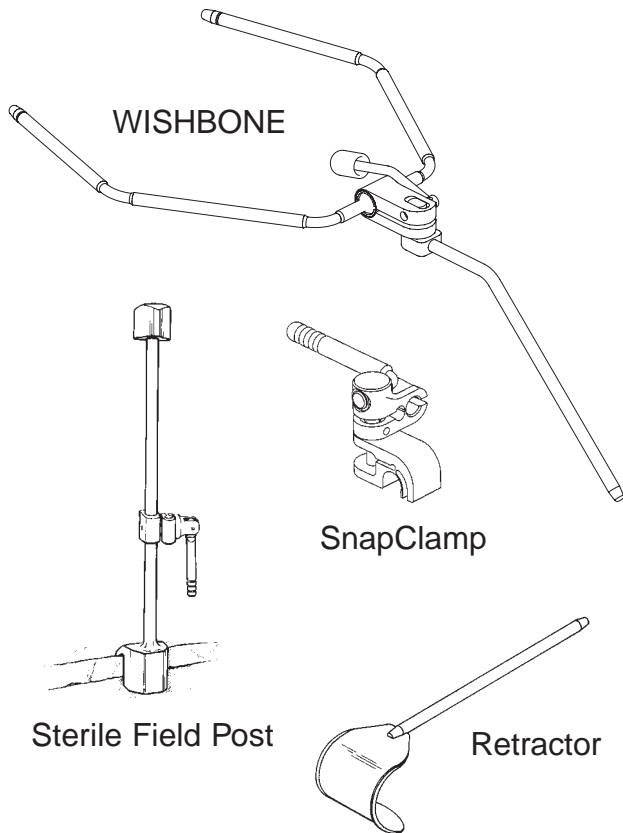

Cleaning: Ultrasonic cleaning is recommended. Power washing or hand scrubbing with a soft brush is acceptable.

Lubrication: It is important that all components be regularly lubricated with a surgically accepted instrument lubricant.

Sterilization:

Gravity Sterilizer -

3 minutes at 270°F/132°C

Prevacuum Sterilizer -

3 minutes at 270°F/132°C

Note: Excessive and prolonged periods of retraction can cause tissue necrosis. **Be sure to relax retractors every 20 minutes.**

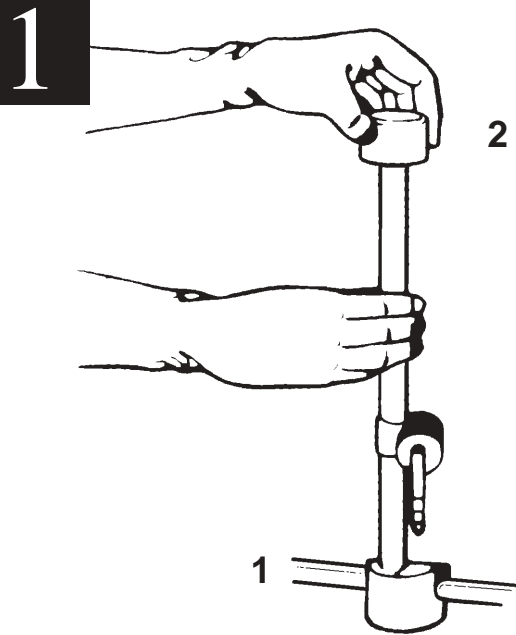

Place the Omni-Clamp Sterile Post on to the table rail over the drape (1). Rotate the knob at the top of the post clockwise to secure it to the table rail (2).

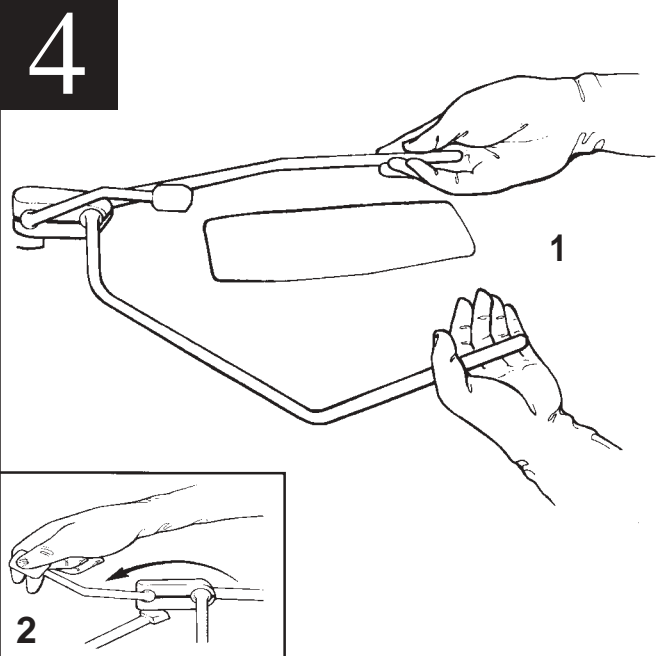

Adjust the WISHBONE arms appropriately (1). Lock the position by pushing the large handle back (2).

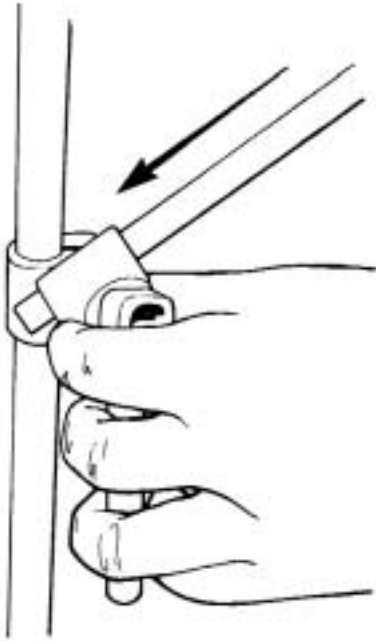
2

The clamp attached to the sterile field post should be positioned opposite the patient. While supporting the clamp, insert the WISHBONE support arm.

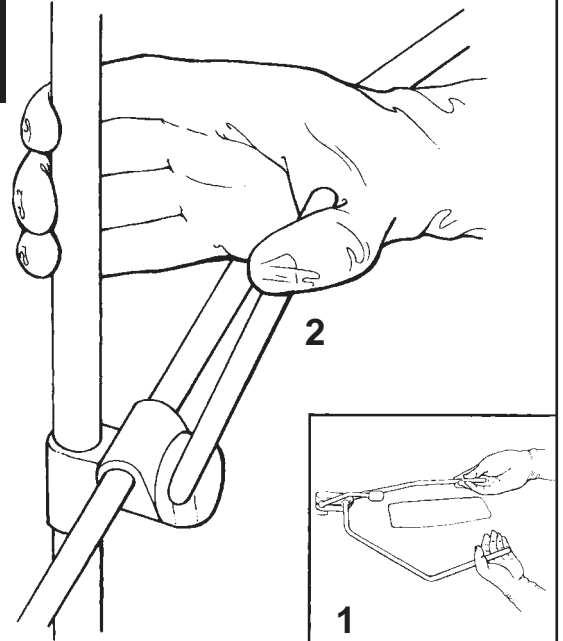
3

With the sterile field post clamp unlocked, position the WISHBONE frame assembly over the patient in a low profile (1). Lock in place by pushing the clamp handle upwards (2).

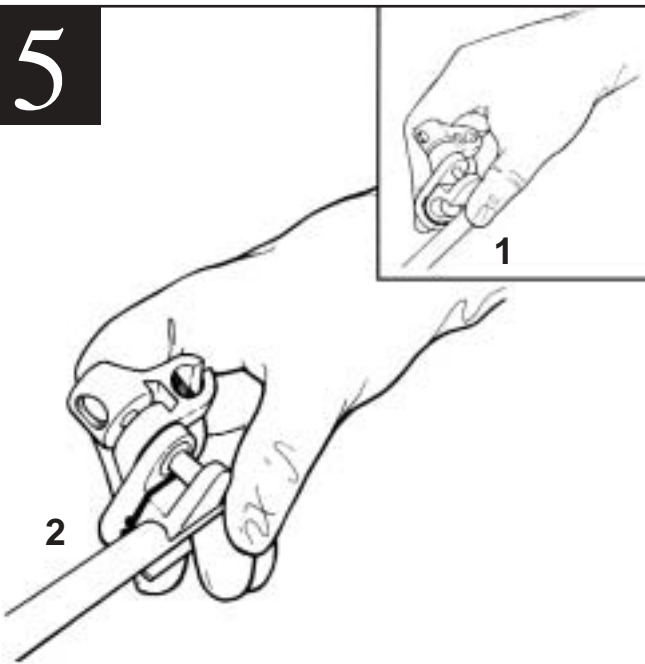
5

To attach SnapClamps, hold the clamp on inside of the frame with the jaws ready to receive the frame (1). Squeeze the clamp on to the frame (2). **(Note: Be sure the handle on the SnapClamp is in the unlocked position.)**

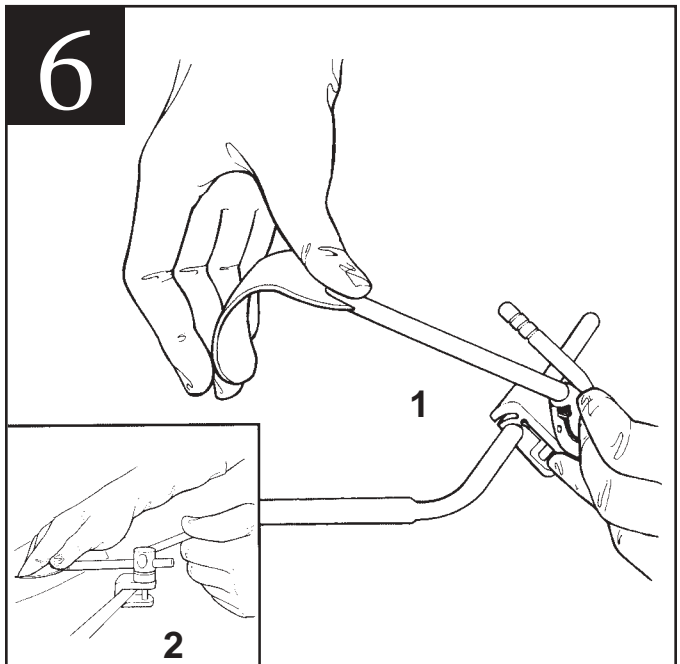
6

Select the appropriate retractor, place the retractor shaft into the clamp and introduce the blade into the wound (1). Secure the retractor in the desired position by pushing the SnapClamp securing handle into the locked position (2).

These are some common configurations for positioning your retractor system, please keep in mind these are suggested guidelines only. Omni-Tract systems are very flexible, therefore these suggested guidelines should be used for reference only.

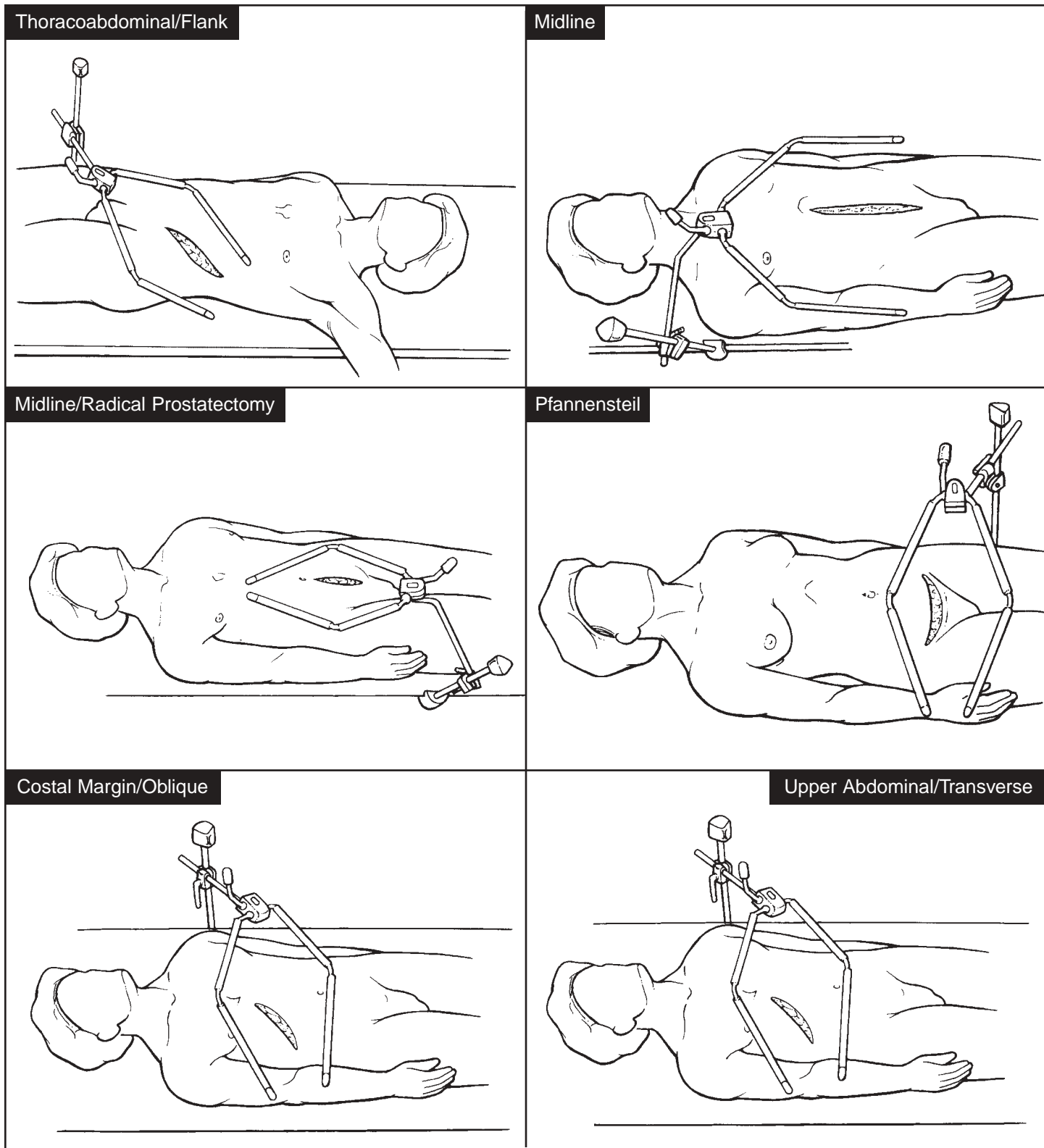

A Division of Minnesota Scientific, Inc.

4849 White Bear Parkway, St. Paul, MN 55110 USA
 651-287-4300 • fax: 651-287-4400 • 1-800-367-8657
<http://www.omni-tract.com>

